

p915.2 915-915-032 / Transaxle

ILLUSTRATION SHOWS TYPICAL PARTS ONLY. ORDER BY PART NUMBER. PARTS NOT LISTED ARE SUPPLIED BY OEM.

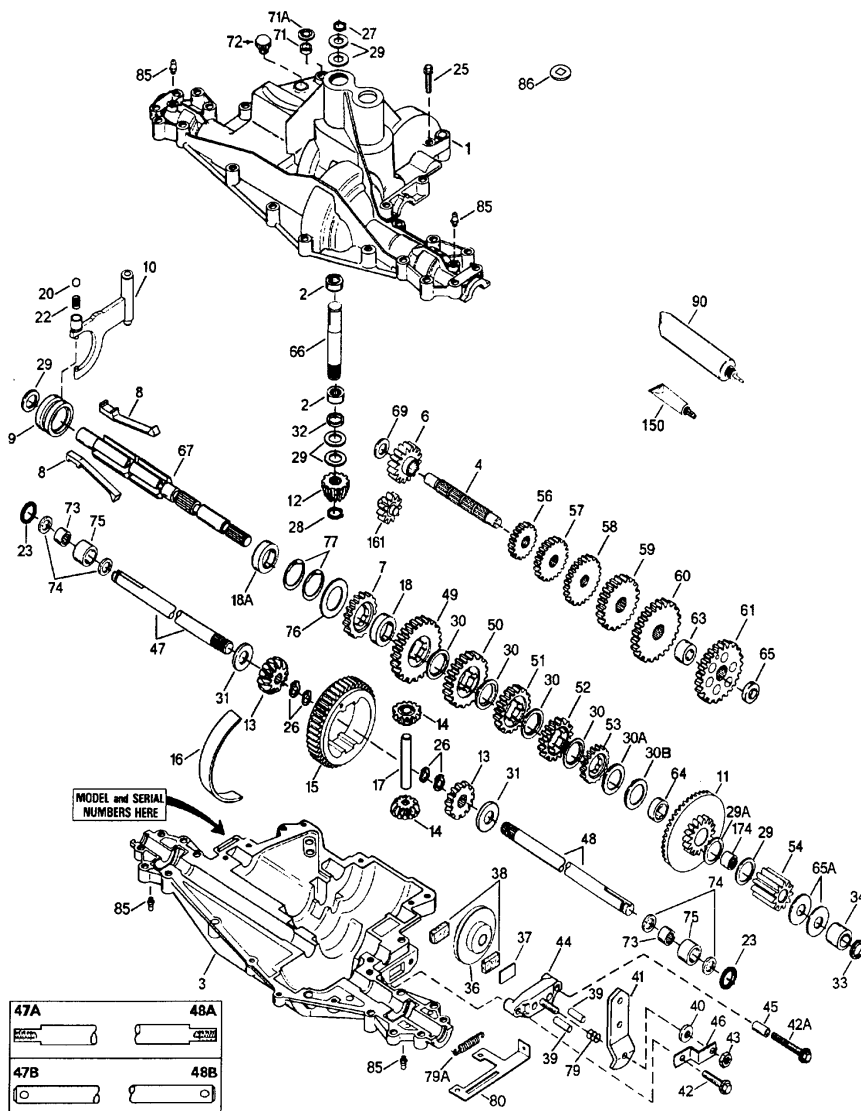

## Part List

p915.2 915-915-032 / Transaxle

| REF # | ITEM #  | DESCRIPTION                         | QTY | REMARK |
|-------|---------|-------------------------------------|-----|--------|
| 1     | 772153  | Transaxle Cover                     | 1   |        |
| 2     | 780086  | Needle Bering .625ID                | 2   |        |
| 3     | 770110  | Transaxle Case (Cast)               | 1   |        |
| 4     | 776300  | Countershaft                        | 1   |        |
| 6     | 778281  | Spur Gear 16T                       | 1   |        |
| 7     | 778122A | Spur Gear 22T                       | 1   |        |
| 8     | 792160  | Shift Key                           | 4   |        |
| 8A    | 792047  | Woodruff Key #9                     | 1   |        |
| 9     | 784352  | Shift Collar                        | 1   |        |
| 10    | 784365  | Shift Rod & Fork                    | 1   |        |
| 11A   | 778290A | Bevel Gear & Bearing (Incl. 174)    | 1   |        |
| 12    | 778262  | Bevel Pinion 14T                    | 1   |        |
| 13    | 778368  | Bevel Gear 13T Incl. 14             | 2   |        |
| 14    | 778368  | Bevel Pinion 13T (Incl. 13)         | 2   |        |
| 15    | 778260  | Ring Gear 43T                       | 1   |        |
| 16    | 786150  | Bearing Strip                       | 1   |        |
| 17    | 786139  | Drive Pin                           | 1   |        |
| 18    | 786147  | Neutral Sleeve .453L                | 1   |        |
| 18A   | 786159  | Neutral Sleeve .390L                | 1   |        |
| 20    | 792139  | Steel Ball 3/8 Diameter             | 1   |        |
| 22    | 792142  | Spring .385OD .6094L                | 1   |        |
| 23    | 788061  | Seal Ring                           | 2   |        |
| 25    | 792073A | Screw 1/4-20 x 1.25                 | 17  |        |
| 26    | 792125  | Retaining Ring (pkg of 2)           | 4   |        |
| 27    | 792035  | Retaining Ring                      | 1   |        |
| 28    | 788040  | Retaining Ring                      | 1   |        |
| 29    | 780072  | Thrust Washer .627ID .031W          | 6   |        |
| 30    | 780108  | Cup Washer 1.127ID .032W            | 4   |        |
| 30A   | 780145  | Washer 1.127ID .032W                | 1   |        |
| 30B   | 780178  | Flat Washer .835ID .031W            | 1   |        |
| 31    | 780001  | Flat Washer .750ID .56W             | 2   |        |
| 32    | 792001  | O-ring .607ID                       | 1   |        |
| 33    | 788076  | O-Ring .530ID                       | 1   |        |
| 34    | 780159  | Bushing .5635                       | 1   |        |
| 36    | 790071  | Brake Disk                          | 1   |        |
| 37    | 790007  | Brake Pad Plate                     | 1   |        |
| 38    | 799021  | Brake Pad                           | 2   |        |
| 39    | 786026  | Dowel Pin 5/16 x 3/4                | 2   |        |
| 40    | 792076A | Flat Washer .312ID .059W            | 1   |        |
| 41    | 790096  | Brake Lever                         | 1   |        |
| 42    | 792073A | Screw, 1/4-20 x 1.25                | 2   |        |
| 43    | 792075  | Lock Nut 5/16-24                    | 1   |        |
| 44    | 790025  | Brake Pad Holder                    | 1   |        |
| 46    | 786086  | Brake Lever Bracket                 | 1   |        |
| 47    | 775105  | Axle 17.188                         | 1   |        |
| 48    | 774665  | Axle 12.000 (Incl. 2 of 26)         | 1   |        |
| 49    | 778381  | Spur Gear 35T                       | 1   |        |
| 50    | 778374  | Spur Gear 30T                       | 1   |        |
| 51    | 778375  | Spur Gear 25T                       | 1   |        |
| 52    | 778278  | Spur Gear 22T                       | 1   |        |
| 53    | 778287  | Spur Gear 19T                       | 1   |        |
| 54    | 778263  | Spur Gear 11T                       | 1   |        |
| 56    | 778193  | Spur Gear 15T                       | 1   |        |
| 57    | 778184  | Spur Gear 20T                       | 1   |        |
| 58    | 778297  | Spur Gear 25T                       | 1   |        |
| 59    | 778380  | Spur Gear 28T                       | 1   |        |
| 60    | 778285  | Spur Gear 31T                       | 1   |        |
| 61    | 778265  | Spur Gear 34T                       | 1   |        |
| 63    | 786155A | Spacer .765 x .559                  | 1   |        |
| 65    | 780162  | Thrust Washer .703ID .091W          | 1   |        |
| 65A   | 780160  | Thrust Washer .563ID .031W          | 2   |        |
| 66    | 776299  | Input Shaft                         | 1   |        |
| 67    | 776352  | Shifter & Brake Shaft               | 1   |        |
| 69    | 780161  | Thrust Washer .703ID .031W          | 1   |        |
| 71    | 788069  | Square Cut Ring .475ID              | 1   |        |
| 76    | 780090  | Flat Washer 1.128ID .058W           | 1   |        |
| 77    | 788078A | Inverted Retaining Ring (pkg. of 2) | 1   |        |
| 79    | 792144  | Spring .430OD .500L                 | 1   |        |
| 90    | 788067B | Grease (32 oz. bottle Bentonite)    | 1   |        |
| 150   | 510334  | Liquid Gasket Anaerobic             | 1   |        |
| 161   | 776302  | Reverse Idler                       | 1   |        |
| 174   | 780085  | Needle Bearing .625ID               | 1   |        |

